

MANUALES: GRANADA Y PAÍSES BAJOS

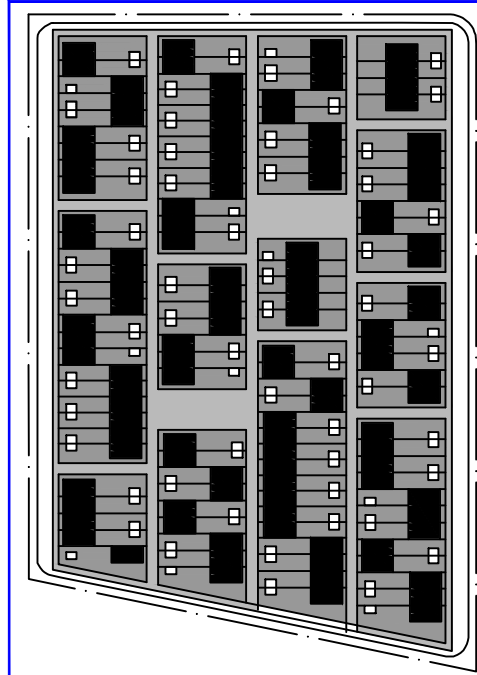

La Haya				
Superficie de Tejido	850,42	664,99	27026,07	0,04376940487
Edificabilidad FSI	35191,68	27026,07		1,302138269
Ocupación GSI	5865,28	27026,07		0,2170230448
Relación de espacio público OSR				0,6013009325
Altura media L				6
Desidad de red N				0,04376940487
Amplitud de malla w				45,69401859
Ancho b				24,40712544
Tara T				0,7829769552
PIL				0,2170230448

- Doctrines which have been argued for through history, polemically translated into density thresholds in the Spacemate.
- 1 Unwin (1912)
 - 2 Hoenig (1920s)
 - 3 le Corbusier (1920s)
 - 4 Gropius (1930)
 - 5 Jacobs (1961)
 - 6 Lozano (1990)

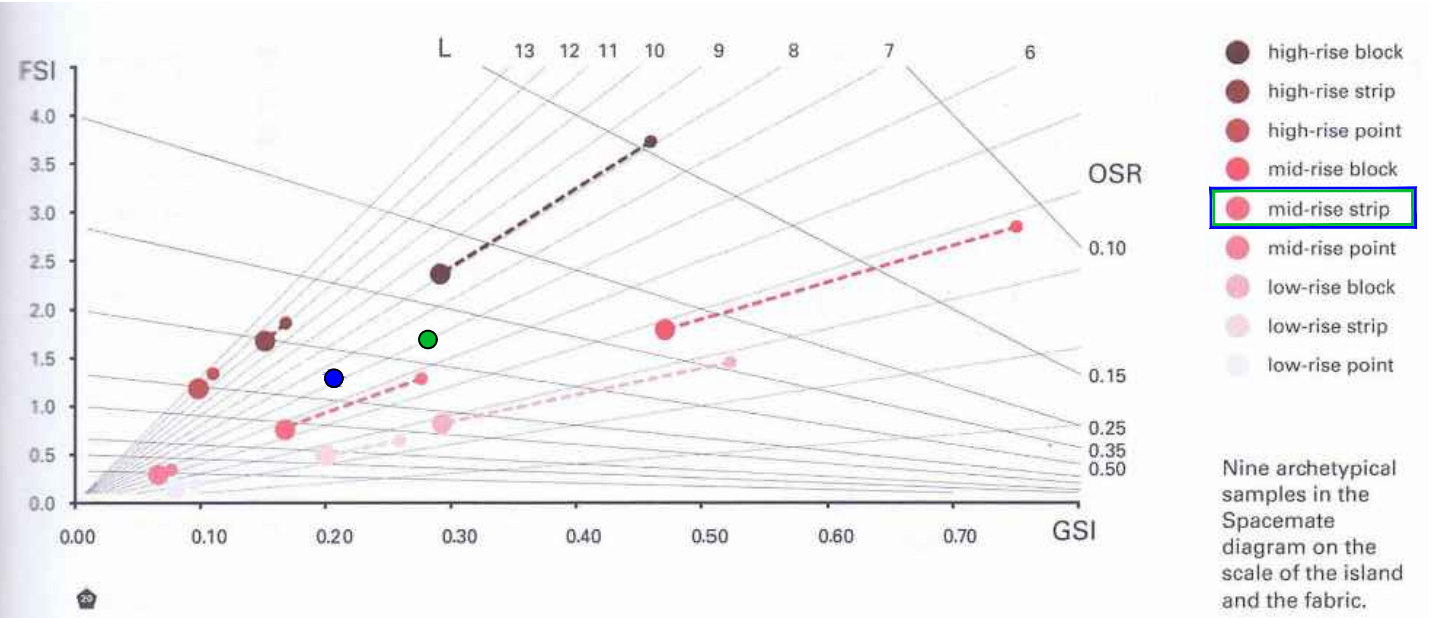

Nine archetypal samples in the Spacemate diagram on the scale of the island and the fabric.

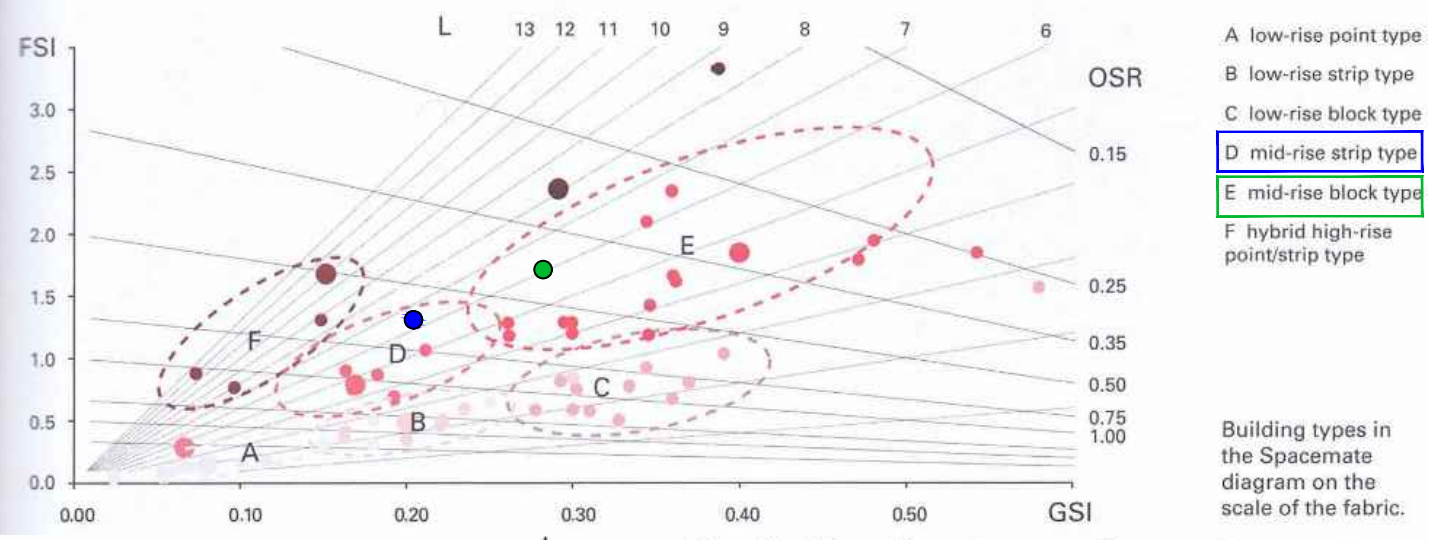

A low-rise point type
B low-rise strip type
C low-rise block type
D mid-rise strip type
E mid-rise block type
F hybrid high-rise point/strip type

Building types in the Spacemate diagram on the scale of the fabric.

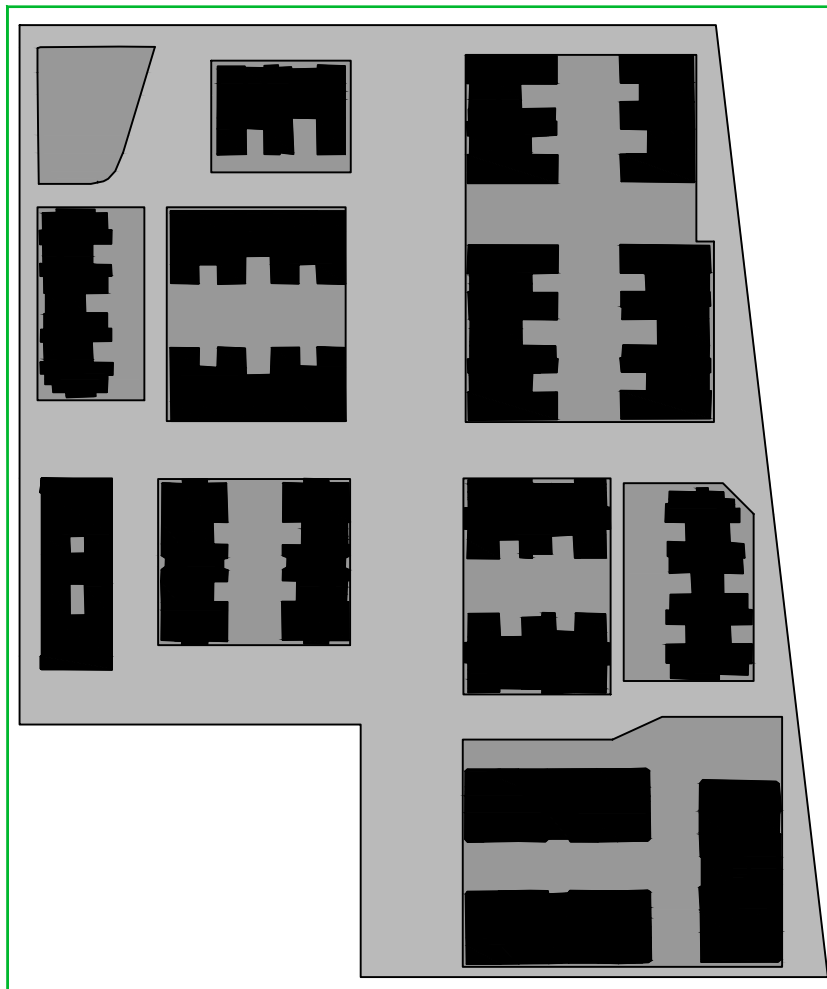

Granada				
Superficie de Tejido	540	1073	62303,02	0,01727845616
Edificabilidad FSI	106043,7	62303,02		1,70206356
Ocupación GSI	17673,95	62303,02		0,2836772599
Relación de espacio público OSR				0,4208554586
Altura media L				6
Desidad de red N				0,01727845616
Amplitud de malla w				115,7510822
Ancho b				54,10048019
Tara T		Tf	1	0,7163227401
PIL				0,2836772599

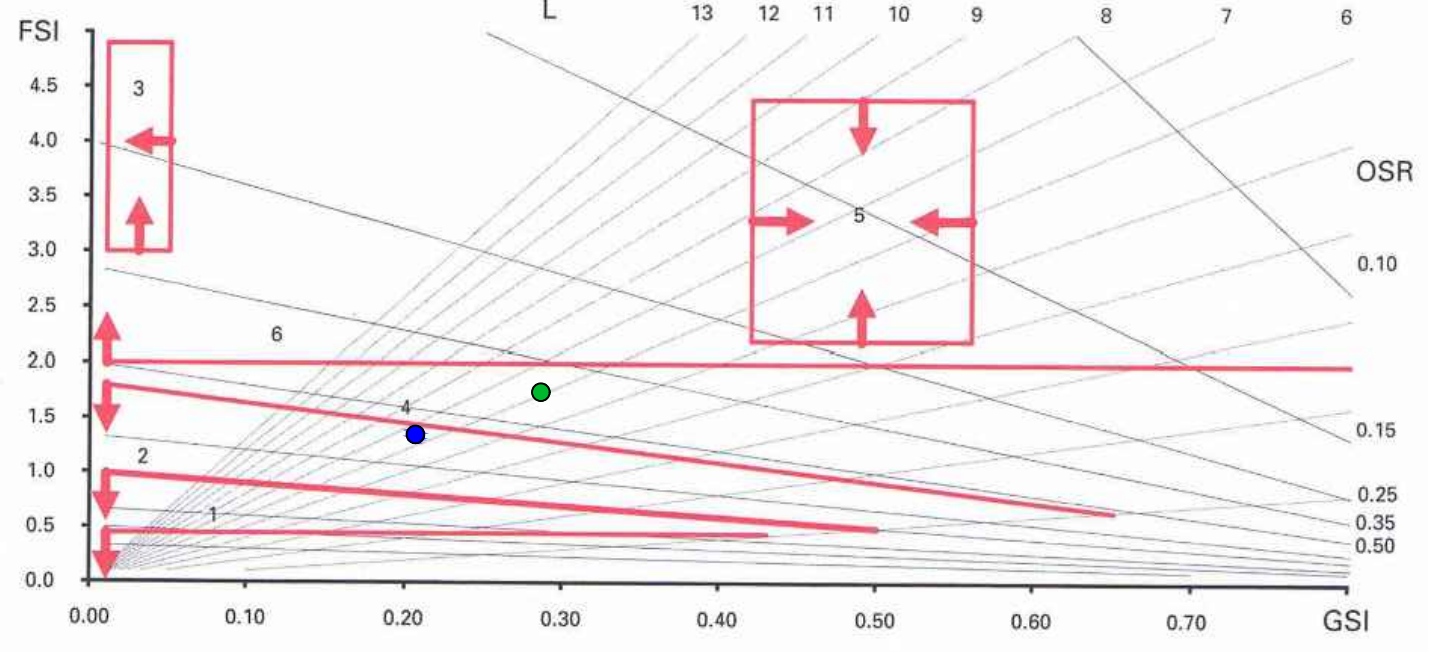

Building types in the Spacemate diagram on the scale of the fabric.